

**Planning and Development Act 2005**

**RESOLUTION TO AMEND LOCAL PLANNING SCHEME**

**City of Greater Geraldton Local Planning Scheme No.1 – Amendment No.18**

Resolved that the City of Greater Geraldton pursuant to section 75 of the *Planning and Development Act 2005*, amends the above Local Planning Scheme by

**1. Under Clause 4.8.1 and in Table 14 of the Scheme Text inserting the following additional development requirements for the subject site**

No.	Description of Land	Requirements
1	Portion of Lots 40 and 41 Geraldton – Mt Magnet Road, Tenindewa	<ol style="list-style-type: none"> <li>1. Industrial uses are to be generally restricted to the processing of vanadium and ancillary activities, including the plant operations, internal access roads, materials storage and laydown areas, evaporation ponds and any other ancillary structures.</li> <li>2. The scale of development is to be consistent with that set out in the s38 Tenindewa Vanadium Processing Facility Proposal Content Document referred to the Environmental Protection Authority (published on the EPA website).</li> <li>3. Additional industrial uses not listed in condition 1 may be contemplated within the development envelope of the vanadium processing plant and ancillary activities, however they will be subject to development approval and at the discretion of Council or other planning decision-maker.</li> <li>4. In considering any future development proposals under condition 3, the decision-maker may refer any part of the proposal to the Environmental Protection Authority that has not been previously referred.</li> <li>5. Prior to subdivision and/or development approval:               <ol style="list-style-type: none"> <li>d) Suitable arrangements for access, intersections and road upgrades are to be made;</li> <li>e) Suitable arrangements are to be made to take water required for the</li> </ol> </li> </ol>

No.	Description of Land	Requirements
		<p style="text-align: center;">land use; and</p> <p style="text-align: center;">f) Suitable arrangements are to be made regarding potential clearing of native vegetation.</p> <p>6. Other conditions may of development be determined by the local government or other planning decision-maker.</p>





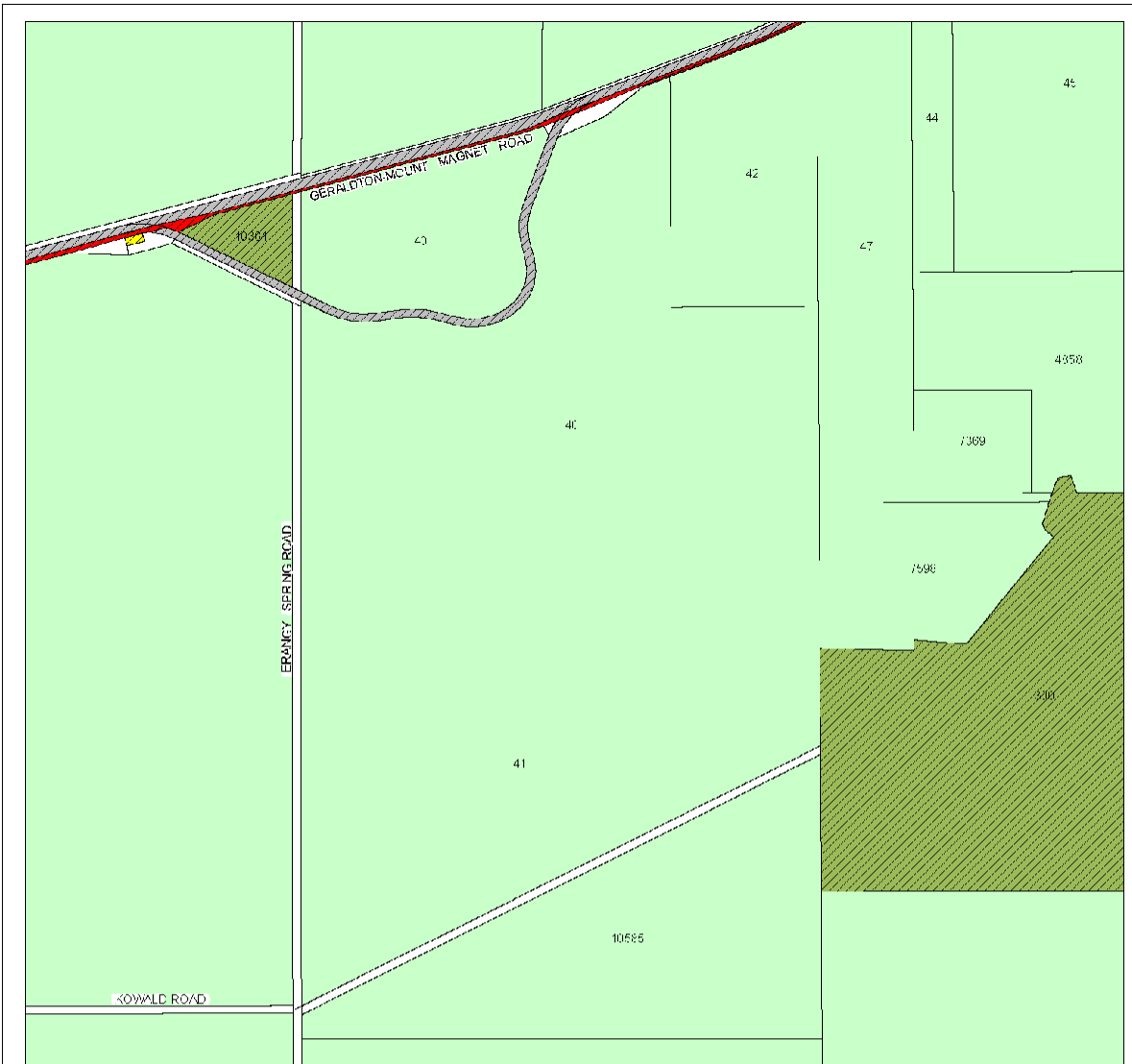

2. Amending the Scheme Map to rezone the site as that portion of Lot 40 and 41 from the Rural to General Industry zone as shown in the attached plan.

# AMENDMENT MAP

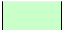

**EXISTING SCHEME MAP**

**Legend**

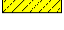
-  Cadastre with Lot number
-  Railways
- LPS Zones**
-  Rural
- LPS Reserves**
-  Environmental conservation reserve
-  Local road
-  Primary distributor road
-  Public purposes



**Department of Planning,  
Lands and Heritage**

**City of Greater Geraldton**

Local Planning Scheme No. 1

Amendment No. 18

Produced by: Data Analytics  
Department of Planning, Lands and Heritage, Perth WA  
Base Information supplied by Western Australia  
Land Information Authority SLIP 180 2020 1

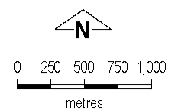

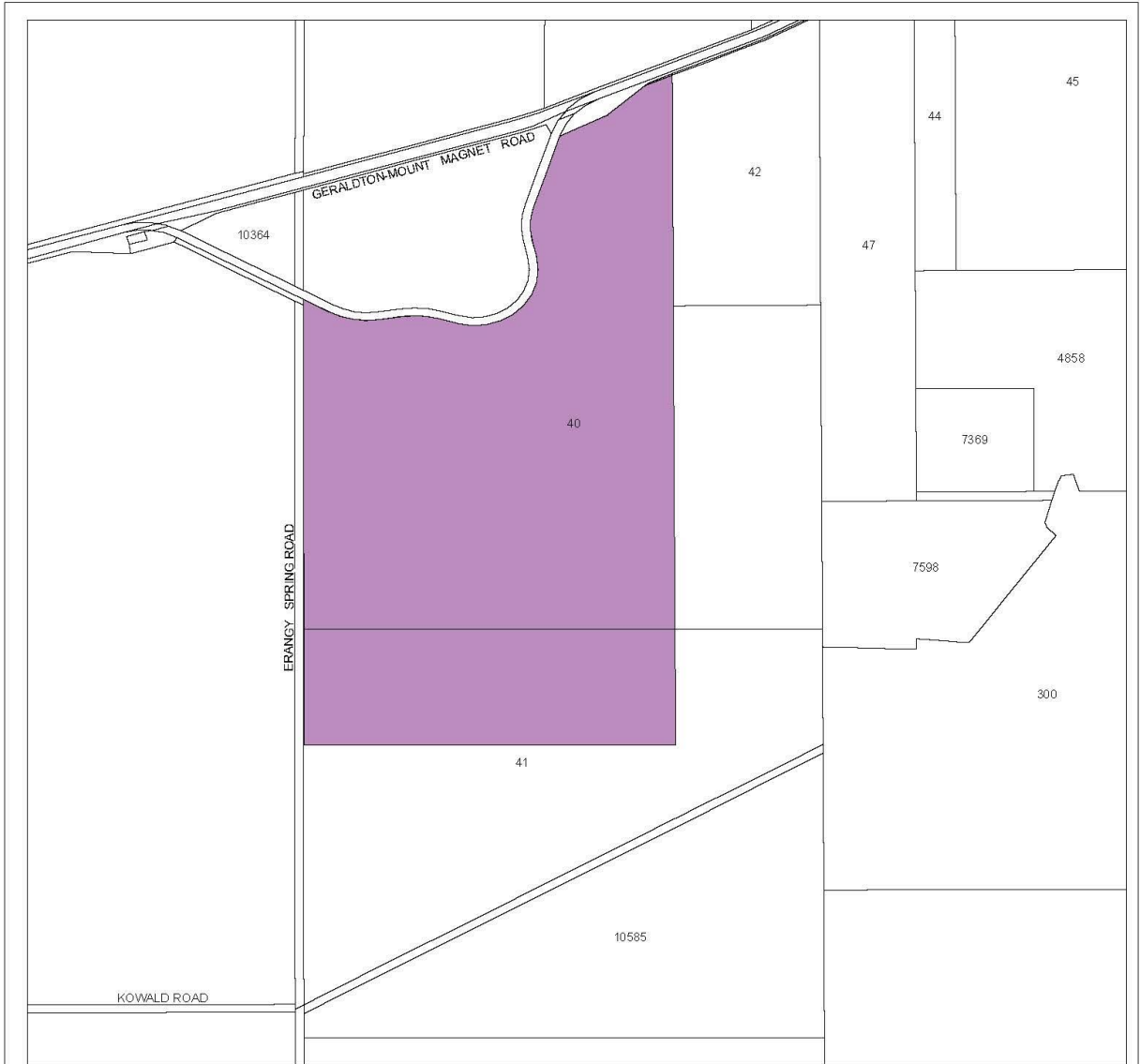

**PROPOSED SCHEME AMENDMENT MAP**

**Legend**

 Cadastre with Lot number

**LPS Zones**

 General industry



**Department of Planning,  
Lands and Heritage**

Produced by Data Analytics,  
Department of Planning, Lands and Heritage, Perth WA  
Base Information supplied by Western Australian  
Land Information Authority SLIP 1180-2020-1

**City of Greater Geraldton**

Local Planning Scheme No. 1

Amendment No. 18

