

**SITE PLAN 1:4000**

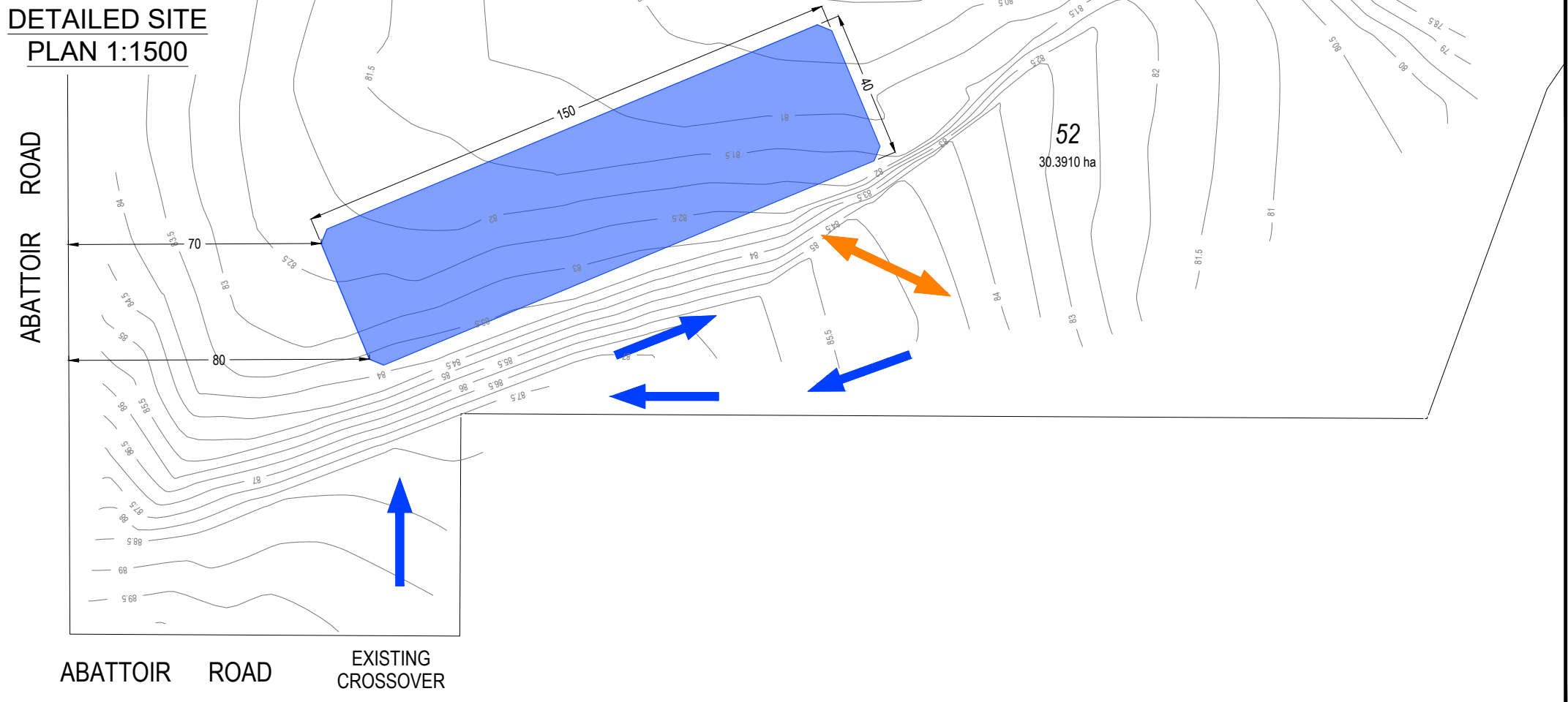

**DETAILED SITE PLAN 1:1500**



**Notes:**

1. Aerial source: Landgate c2023
2. Level Survey source: Quantum Surveys Ref 22119
3. Volume of Sand: Estimated 24,000tn - 30,000tn (as per contract docs) Estimated 14,000m<sup>3</sup> - 18,750m<sup>3</sup>
4. Closest dwelling: 550m
5. No RAV route category vehicles to be used in operations.
6. Plan to be read in conjunction with Operation and Management Plan.

**LEGEND**

- APPROXIMATE AREA FOR STOCKPILING
- TRUCK MOVEMENTS - FORWARD GEAR
- TRUCK MOVEMENTS - FORWARD & REVERSE GEAR

TITLE: DEVELOPEMENT APPLICATION - STOCKPILING  
 LOT 152 ON DEPOSITED PLAN  
 408731 GERALDTON - MT MAGNET ROAD, MOONYOONOOKA

CLIENT: CENTREPOINT EARTHMOVING  
 CERTIFICATE OF TITLE(S) : 2961/497  
 DATE LAST MODIFIED: 17/04/2024

PLAN: 24120-01

REV:	DATE:	DETAILS:
SCALE:	1:4000 @A3	
DESIGNED:	GMB	DRAWN: DW

\* This plan remains the property of Landwest and must not be used for any purpose other than which it was prepared for, in relation to the land duly described, Landwest accepts no responsibility for any losses or damages caused to any person/s who may use the information for a purpose for which it was not intended.