



PROPOSED OPTUS BASE STATION



LOCALITY MAP

COPYRIGHT © GOOGLE MAPS

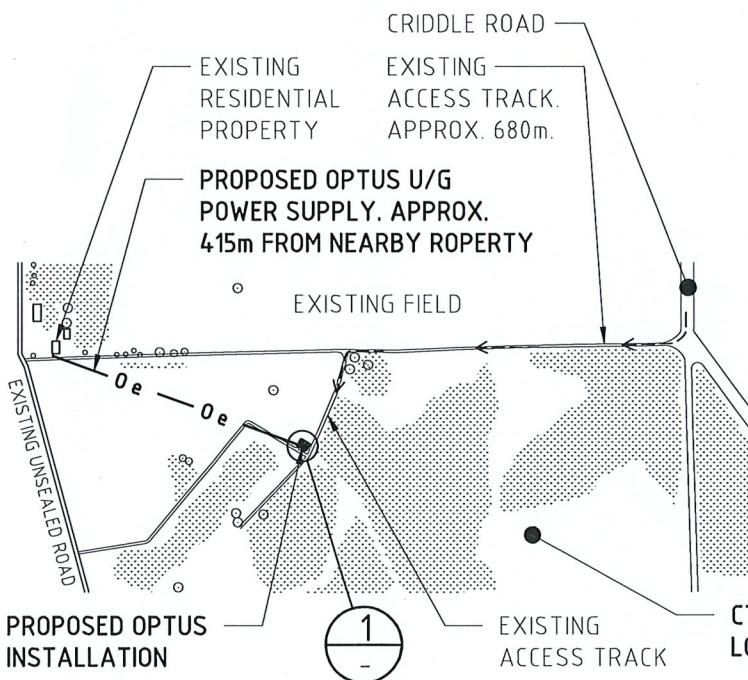

OVERALL SITE PLAN

NOT TO SCALE

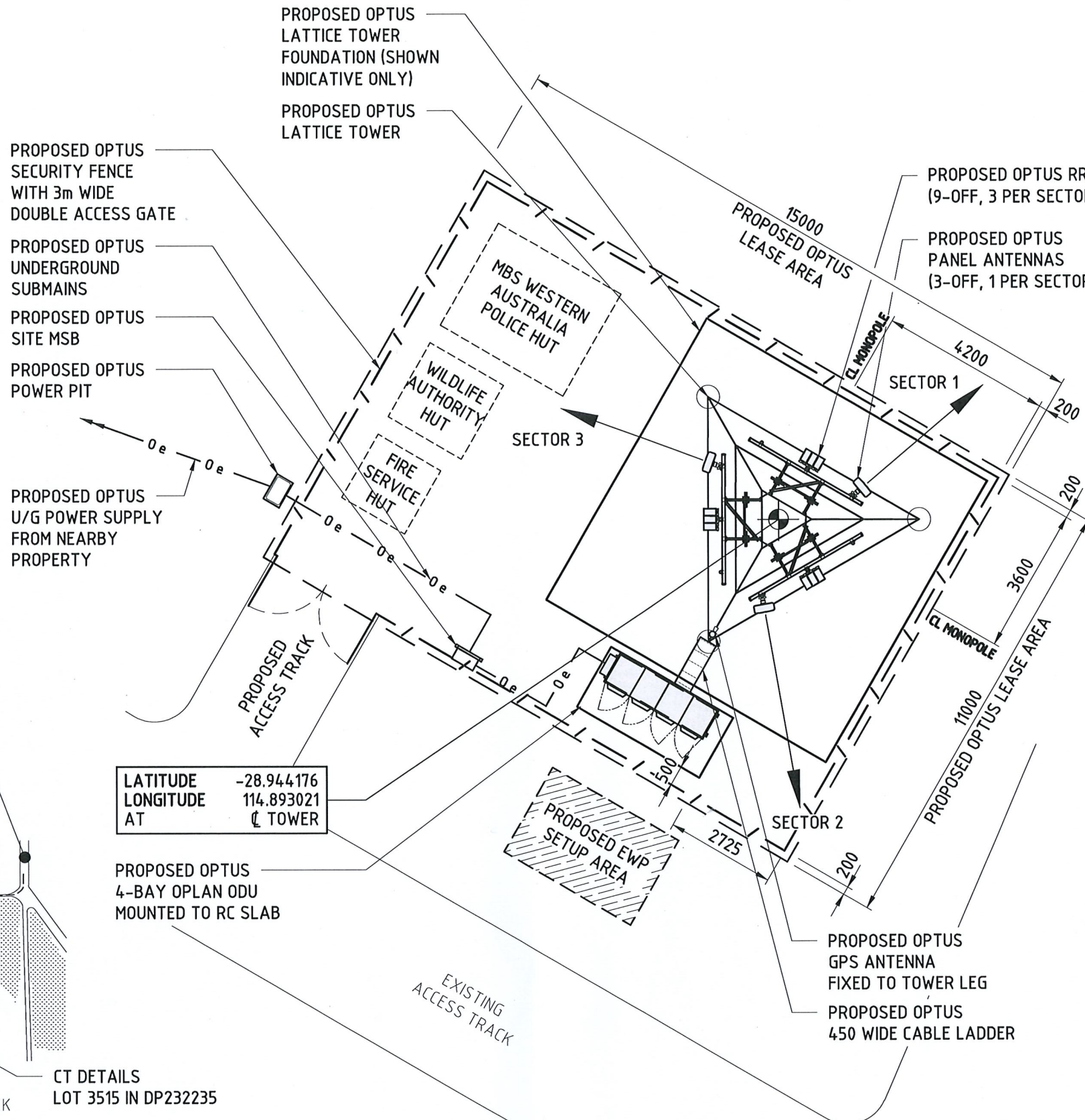

LATITUDE -28.944176
LONGITUDE 114.893021
AT TOWER

DETAIL 1

1:125

NOTE:
THIS DRAWING IS DIAGRAMMATIC ONLY AND SHOULD NOT BE SCALED. DIMENSIONS, COORDINATES, AND LEVELS SHOWN ARE NOMINAL AND SUBJECT TO CONFIRMATION BY SURVEYOR.

SITE ADDRESS:
578 CRIDDLE ROAD,
WALKAWAY, WA 6528

- NOTES:**
- BASIS OF DESIGN**
 - > SITE INSPECTION 30/08/2021
 - PANEL ANTENNAS**
 - > 1-OFF PER SECTOR (EACH 2.688m LONG) AT EL 60.00m
 - > ANTENNA TYPE: COMMSCOPE 12-PORT RRV4-65D-R6
 - > SECTOR 1 - 50°, SECTOR 2 - 170°, SECTOR 3 - 290°
 - > MOUNTED ON PROPOSED TRIANGULAR HEADFRAME ON PROPOSED LATTICE TOWER
 - TRANSMISSION**
 - > SITE TO BE CONNECTED TO THE NETWORK VIA PARABOLIC ANTENNA (SIZE AND HEIGHT TBA).
 - > TO BE CONFIRMED BY OPTUS
 - EQUIPMENT ODU**
 - > 4-BAY OPLAN ODU (12-HR SPECIFIC DESIGN) MOUNTED TO STANDARD RC SLAB
 - OPTUS TOWER**
 - > 60m HIGH STEEL LATTICE TOWER WITH TRIANGULAR HEADFRAME AT EL 60.00m
 - FEEDER CABLES**
 - > SIZE: 9/18 HYBRID FIBRE CABLE ALL SECTORS
 - > LENGTH: 65m ALL SECTORS
 - SITE ACCESS**
 - > ACCESS THROUGH ALLANOOKA SPRINGS ROAD VIA ACCESS TRACKS
 - ANTENNA ACCESS**
 - > VIA ELEVATED WORK PLATFORM
 - POWER SUPPLY**
 - > DETAILS TO BE CONFIRMED VIA POWER VIABILITY AUDIT

Rev	Date	Revision Details	CPS	JY	DL	DL	WS	F+
Consultant	CAD	Designer	Verifier	Approver				
01	10.11.21	ISSUED FOR APPROVAL	CPS	JY	DL	DL	WS	F+



Client: **MOBILE NETWORK AUSTRALIA**
 Project: **SITE N°: P1113 MUMBIDA**
 CRIDDLE RD, WALKAWAY, WA

Drawing Title: **DRAFT SITE LAYOUT**
 Drawing Status: **FOR APPROVAL**
 Drawing No: **P1113-P1**
 Revision: **01**

