



# EDITH COWAN SQUARE

## LOT DETAILS

Reserve No: R50415  
 Lot Details: Lot 602  
 Address: Forrest Street, Geraldton WA 6530  
 Vesting: City of Geraldton-Greenough  
 Purposes: Community Purposes

## LEGEND

-  Cadastral Boundaries
-  Park Boundary (Lot 600)

## GENERAL INFORMATION

Grass Area [W] 26.7m x [L] 37.5m = 1001.25 sqm  
 Facilities Power and Water available in each corner of the grassed area.

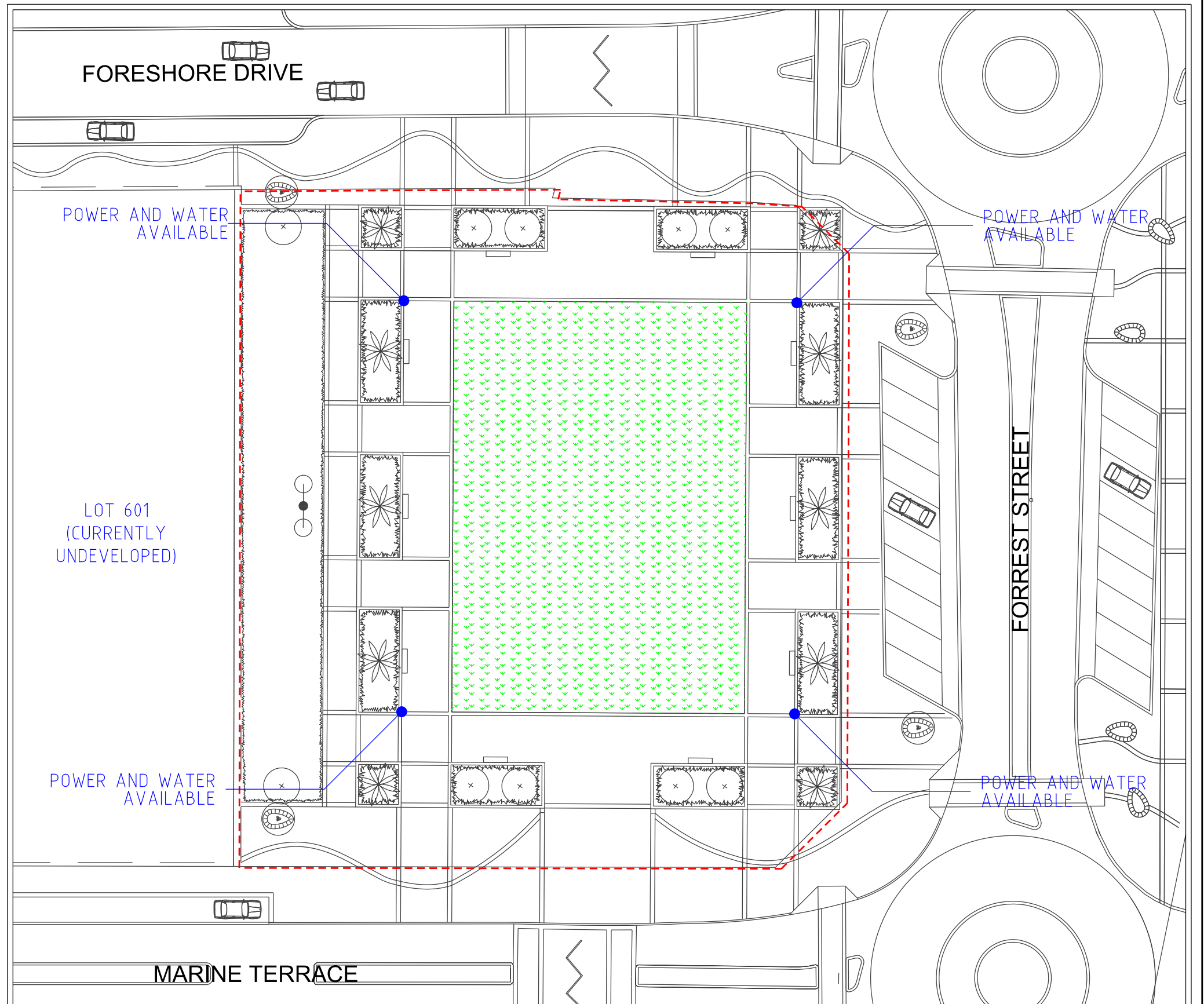

AMENDMENTS	NO.	DATE	DESCRIPTION	BY	APPR.
	2.	AUG-15	UPDATE TITLE BLOCK	RT	
	1.	JUN-14	UPDATE EXISTING DESIGN DRAWING	RT	



PO Box 101 Geraldton WA 6531  
 Geraldton Civic Centre T 08 9956 6600 F 08 9956 6674  
 Mullewa District Office T 08 9956 6643 F 08 9961 1206  
 E council@cgg.wa.gov.au W www.cgg.wa.gov.au

DESIGNED:	HAMES SHARLEY	DATE:	June 2007
DRAWN:	R.J. THORP	DATE:	June 2014
CHECKED:		DATE:	
APPROVED BY:		DATE:	
DEPARTMENT <b>INFRASTRUCTURE SERVICES</b>			

PROJECT TITLE:	<b>CGG PARKS AND OVALS Equipment and Facilities</b>		
DRAWING TITLE:	EDITH COWAN SQUARE, Forrest Street		
FILE LOC:	D-14-40221 (TRIM Reference)	DRAWING NUMBER:	PO155

PAPER SIZE:	A3
SURVEYED BY:	
DATE SURVEYED:	
DATUM:	H V
SCALE:	1:400
REVISION NUMBER:	2